

CONTAINMENT COOLING OUTLINE

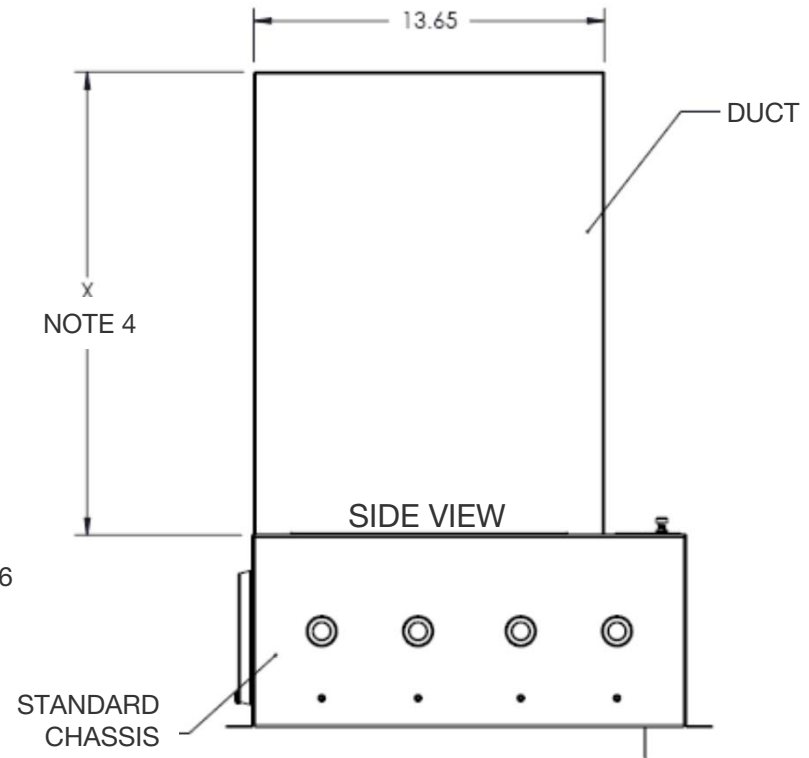

Notes:

1. All dimensions are in inches
2. Unit weight complete minus duct is 44 lbs [ec20 system]
3. Duct weight is approximately 6 lbs per linear ft
4. Duct length is specified per site requirements
5. Chassis can be centered left to right on rack and be placed anywhere from front to rear of rack based on site requirements
6. Extended chassis height is 11.525 inches tall

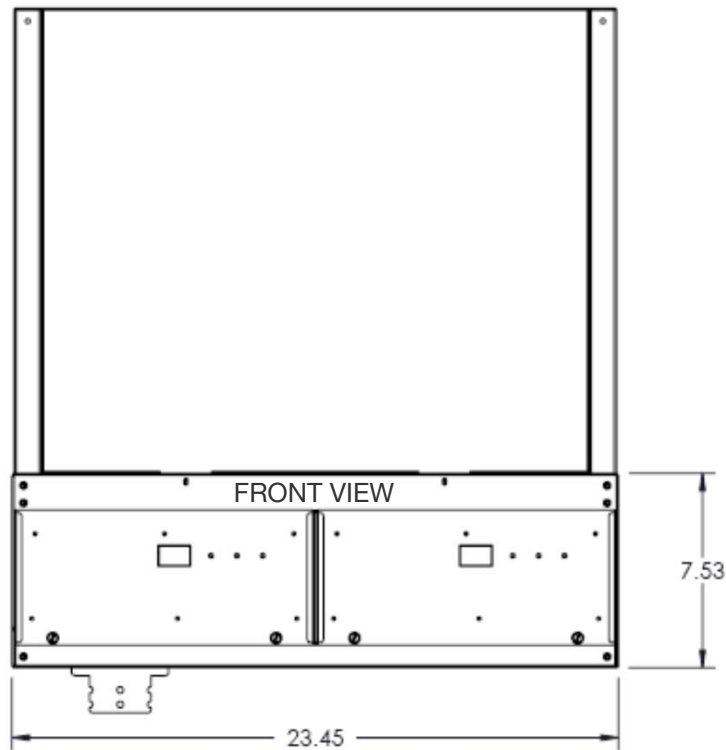
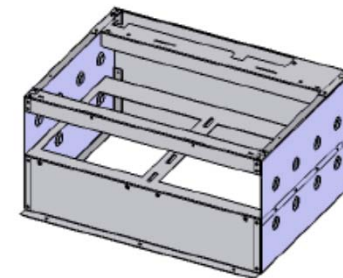

EXTENDED CHASSIS
ISOMETRIC

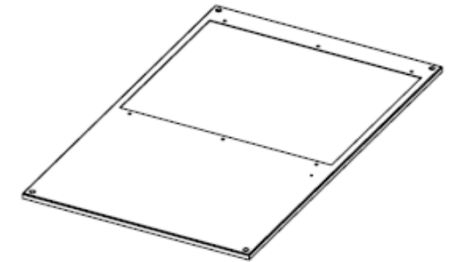
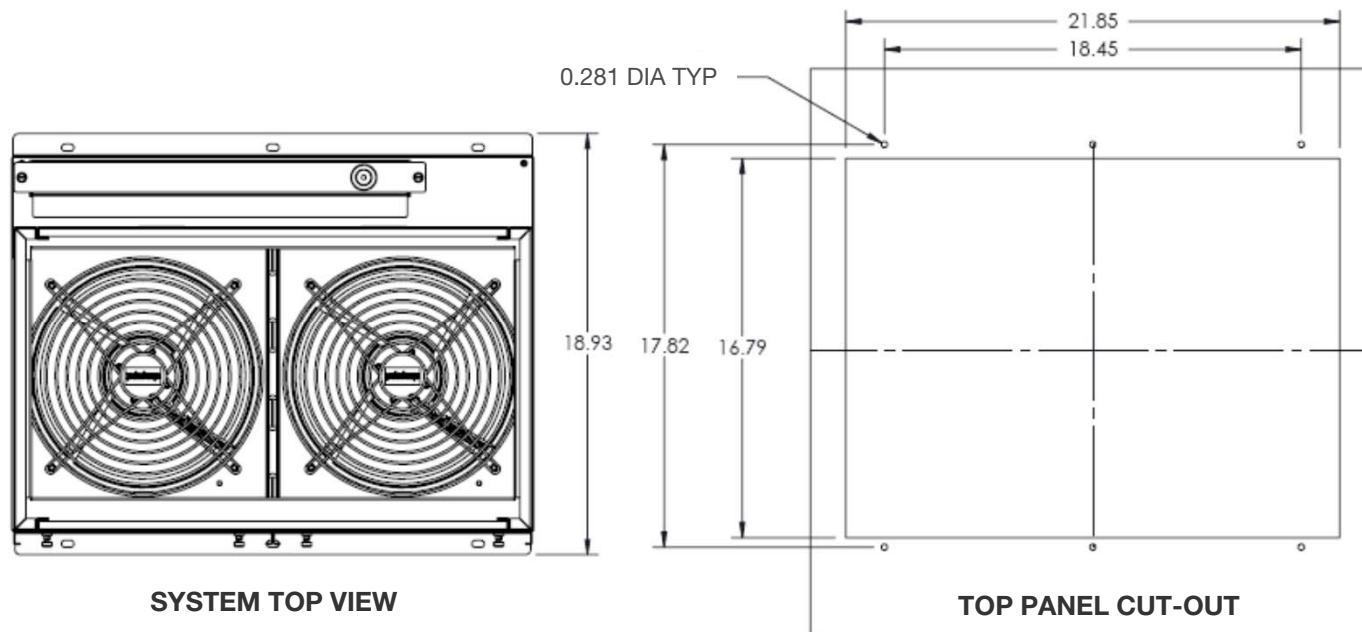

**RACK TOP PANEL
WITH CUT-OUT**

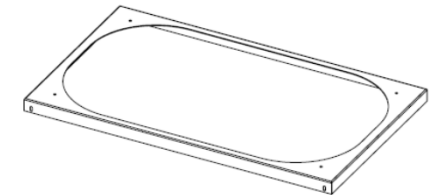

**DUCT CAP FOR 20 INCH
ROUND FLEX DUCT
EXTENSION**

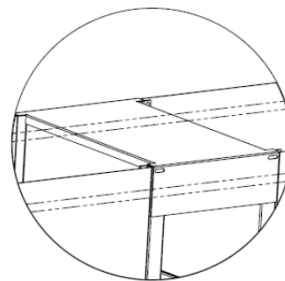

**VIEW A
INTER-DUCT
CONNECTOR**

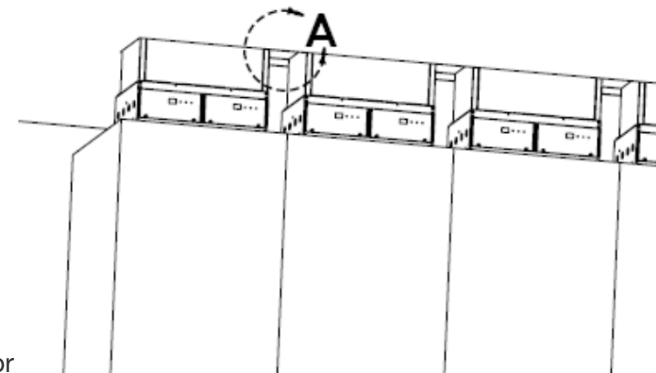

**750 MM RACKS WITH
INTER-DUCT CONNECTORS**

Notes:

1. All dimensions are in inches
2. Chassis can be centered left to right on rack and be placed anywhere from front to rear of rack based on site requirements
3. Top rack panel cut-out shown. Cut-out is suitable for 600 mm, 750 mm, 24 inch or 30 inch wide racks. Specify inter-duct connectors to join adjacent racks.
4. Inter-duct connector flange is 3.0 inches. Size duct length approximately 1.5 inches above ceiling.

CHASSIS ATTACHMENT

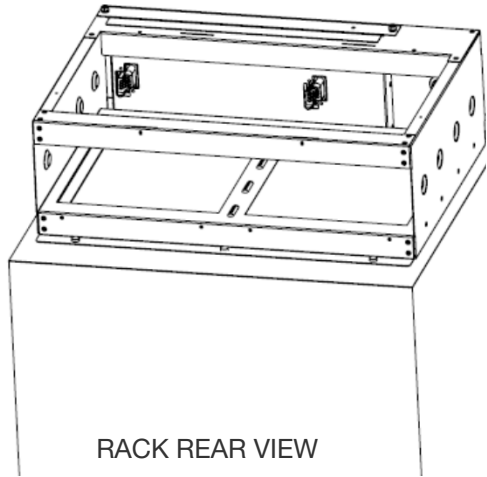

RACK REAR VIEW

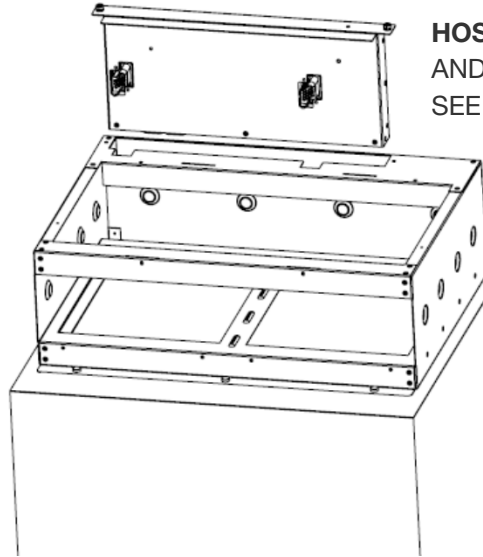

**HOST INSERTION
AND REMOVAL
SEE NOTE 1**

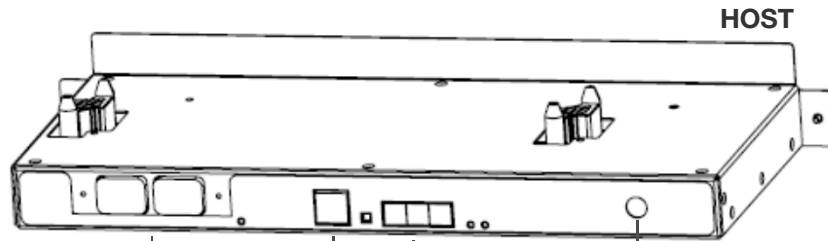

C14 INPUT A/B POWER

RJ45 ETHERNET CONNECTION

RJ11 TEMP/HUMIDITY SENSOR INPUT

PRESSURE SENSOR
CONNECTION

HOST

NOTES:

1. Host removal from chassis requires 8 inches of clearance above top of chassis
2. Chassis can be centered left to right on rack and be placed anywhere from front to rear on rack based on site requirement

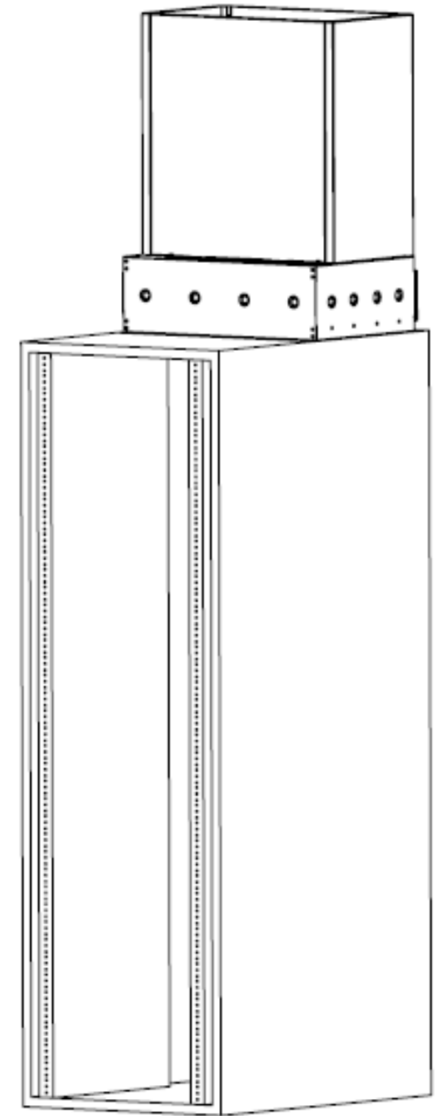

RACK FRONT VIEW

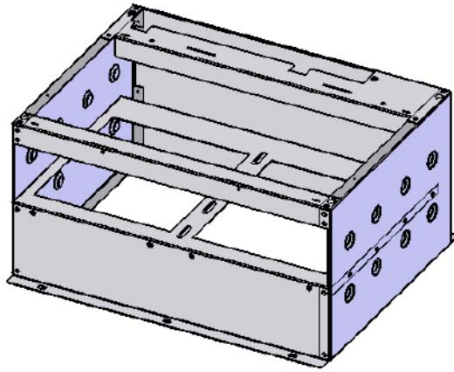

EXTENDED CHASSIS

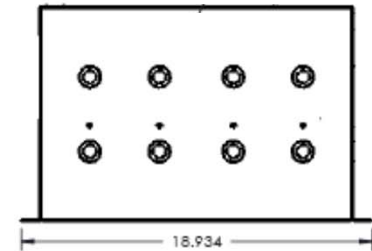
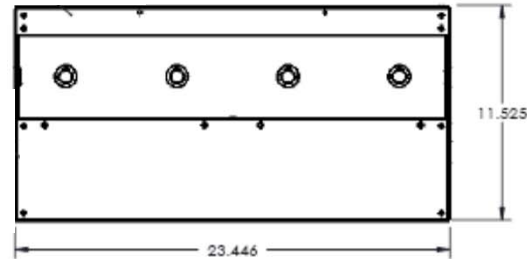
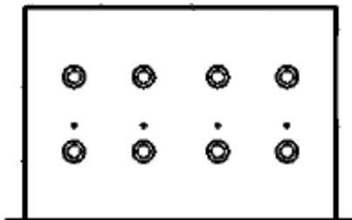
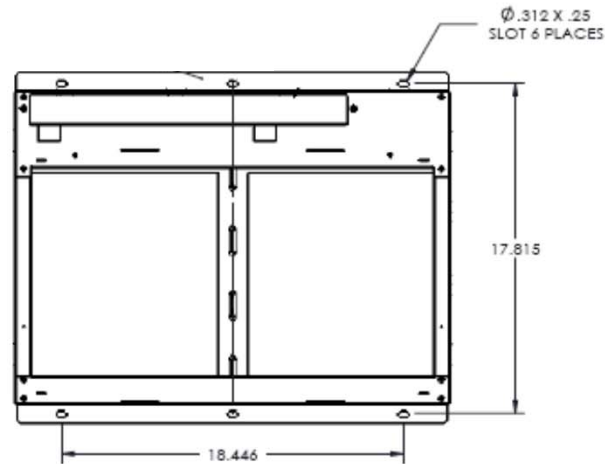
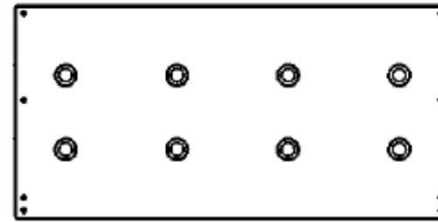

NOTES:

1. Extended chassis outside dimensions are the same as the standard chassis except for the 11.525 inch height
2. Extended chassis rack top panel cut-out and mounting is the same as the standard chassis



ELECTRICAL LINE DRAWING AND REQUIREMENTS

Electrical Requirements	
Input Power	90-240 VAC 50-60 Hz single phase
Input Sources	2
Input Amperage at 208V	EC10: 1.3A EC20: 1.4A
Input Amperage at 230V	EC10: 1.1A EC20: 1.2A
Receptacles	IEC-320 C14
Airflow (CFM)	EC10: 1200 EC20: 2034

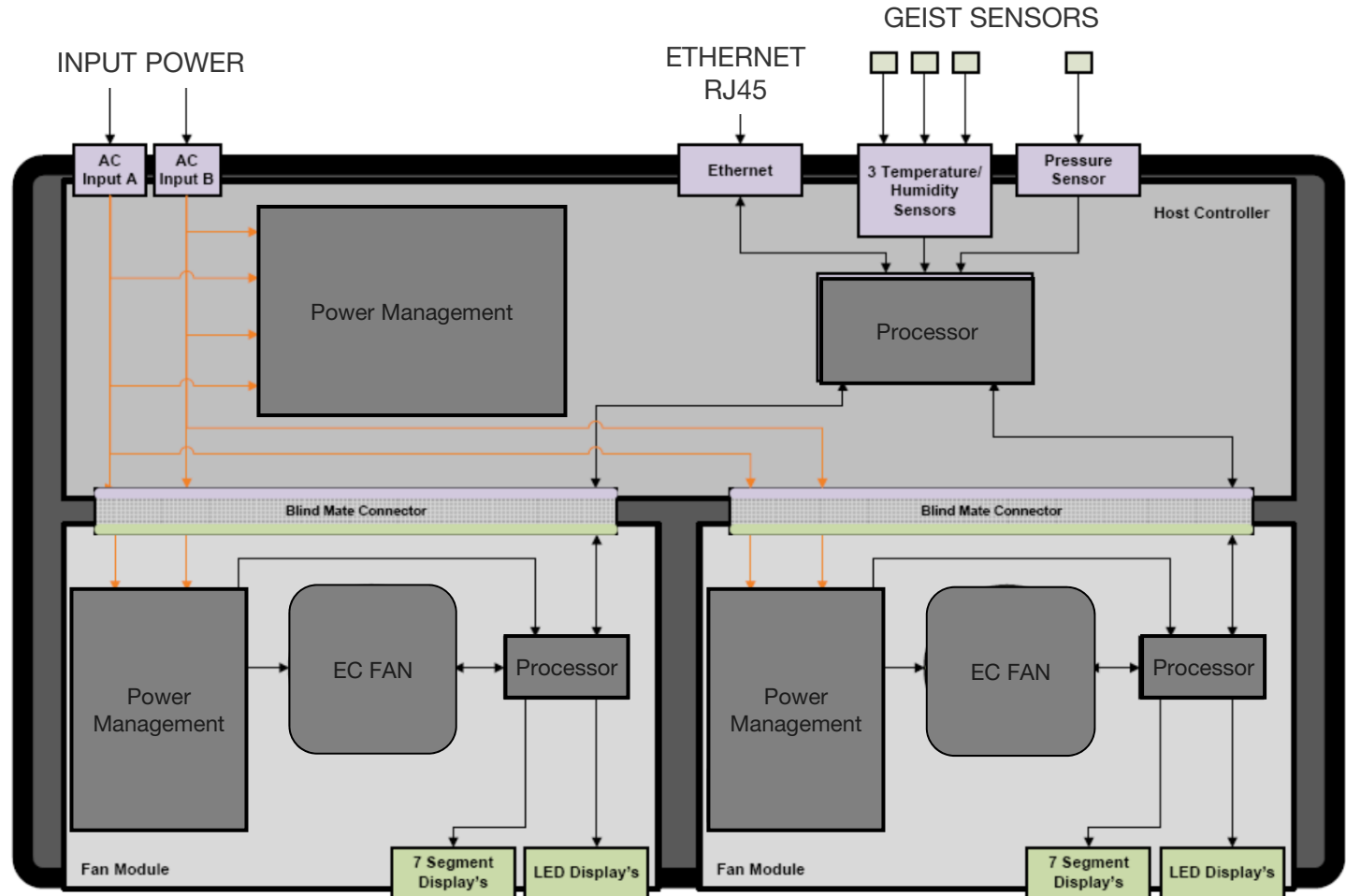

Geist Americas

800.432.3219
geistglobal.com
Geist DCiM
1.877.449.4150
geistglobal.com

Geist Europe

+44 (0) 1823 275100
geisteurope.com

Geist Asia

China
+86.755.86639505
geistglobal.com

Hong Kong

+852.90361927
geistglobal.com