



# GEIST MONITOR

## Analog to Digital Converter

Part Number: A2D

The A2D allows you to interface an analog sensor to a Plug-n-Play port. It is compatible with the Watchdog 15/100 environment monitors and Geist Upgradeable PDUs

### Features

- Plug-n-Play
- Configurable Unit Measurements
- Daisy-Chain Capable

### Sensor Compatibility

- Door Position
- Power Failure
- Water Sensing Cable
- Flood Sensor
- Isolated Voltage
- Smoke Alarm
- Industry Standard 0-10V or 4-20mA



Plug-n-Play Ports

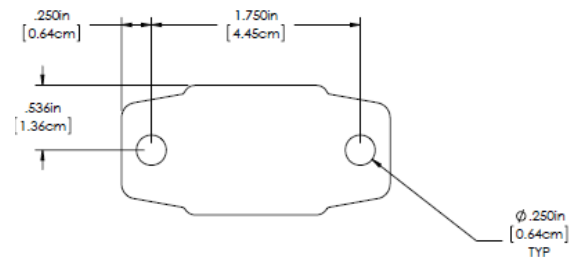
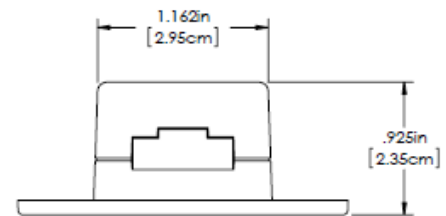
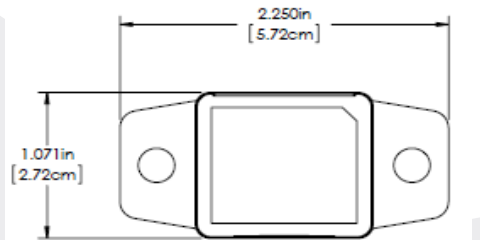
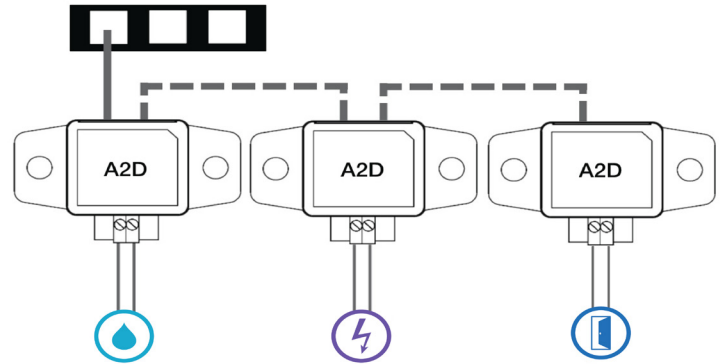

### Specifications

Input Rating	0-10VDC, 4-20mA, or dry contact
Operating Temperature	-20°C to +75°C (-4°F to +167°F)
Operating Altitude Limit	3,050m (10,000ft) above MSL
Operating Relative Humidity	5-95%
Connections	Digital In , Digital Out and Analog In
Enclosure Size LxWxH	57.15mm x 27.20mm x 23.49mm (2.250in x 1.071in x 0.925in)
Mounting Hole Size	6.35mm (0.25in)
Cable Type	Includes a 3m (10ft) or 50m (15ft) uplink cable to connect to the host
Cable Length	3m, 15m (10ft, 50ft)
Compatibility	Watchdog 15/100 and Geist Upgradeable PDUs with firmware v3.0 or greater
Warranty	1 year

[geistglobal.com](http://geistglobal.com)

Geist Americas

800.432.3219  
[geistglobal.com](http://geistglobal.com)

Geist DCIM  
1.877.449.4150  
[geistglobal.com](http://geistglobal.com)

Geist Europe

+44 (0) 1823.275100  
[geistglobal.com](http://geistglobal.com)

Geist Asia

China  
+86.755.86639505  
[geistglobal.com](http://geistglobal.com)

Hong Kong  
+852.81764860  
[geistglobal.com](http://geistglobal.com)

10015203